

**HONDA**  
ENGINES

# GX 670

Horizontal shaft gasoline (petrol) engine

- Moteur à essence à arbre de sortie horizontal
- Benzinmotor mit horizontaler Kurbelwelle
- Motore a benzina ad albero orizzontale



17.7 kW (24 HP) / 3 600 min<sup>-1</sup>

# Dimensions Unit: mm (in.)

## STANDARD TYPE

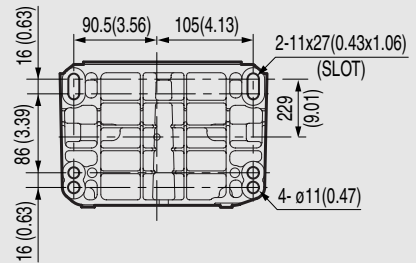
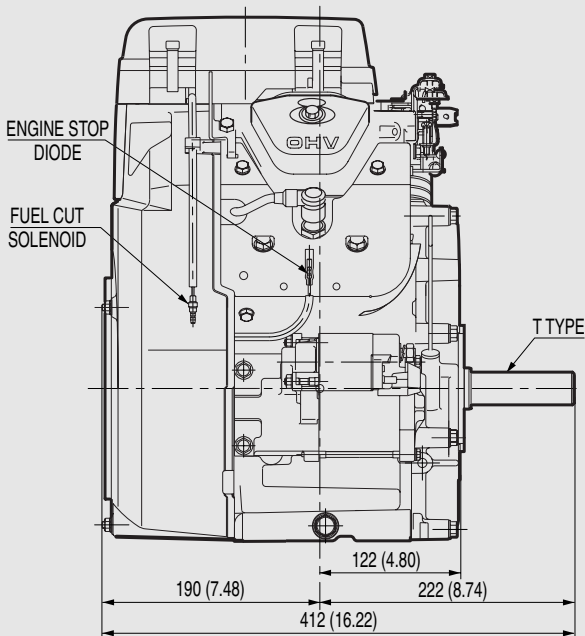
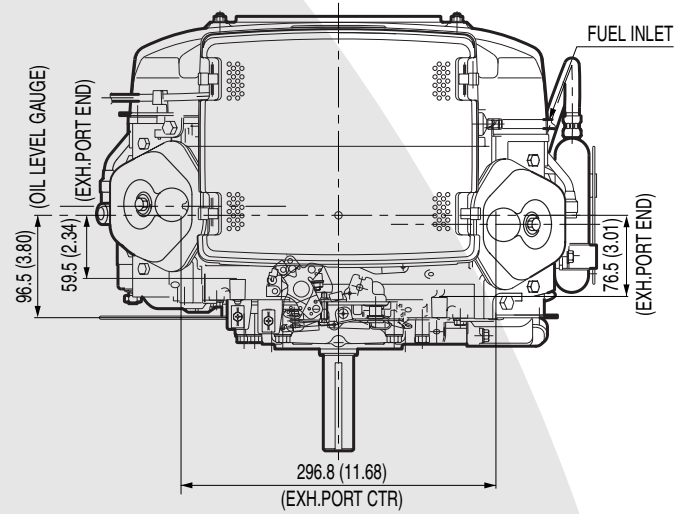
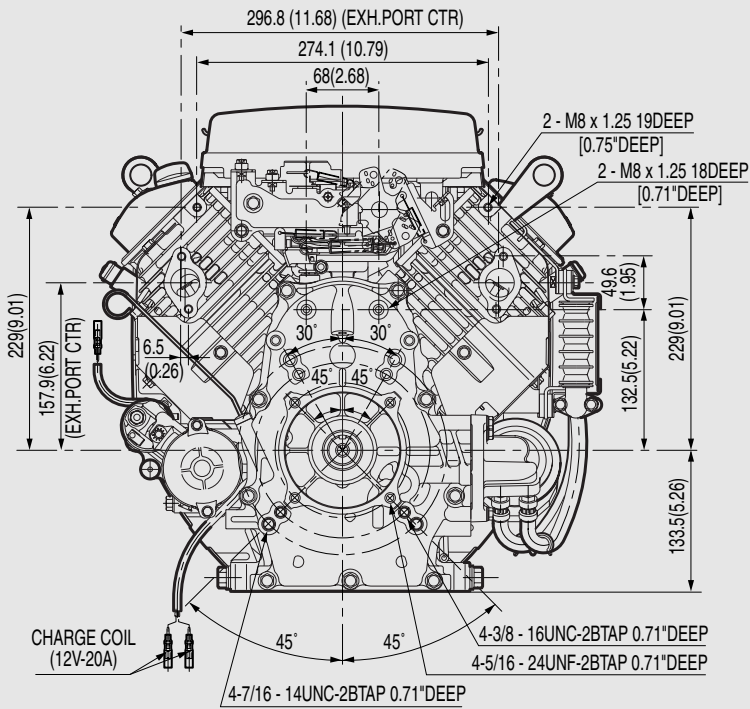

## PTO SHAFT DIMENSIONS

### • B-TYPE

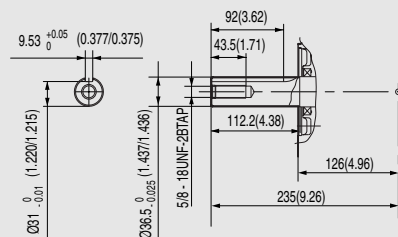

**POWERED by**  
**Honda Engines**

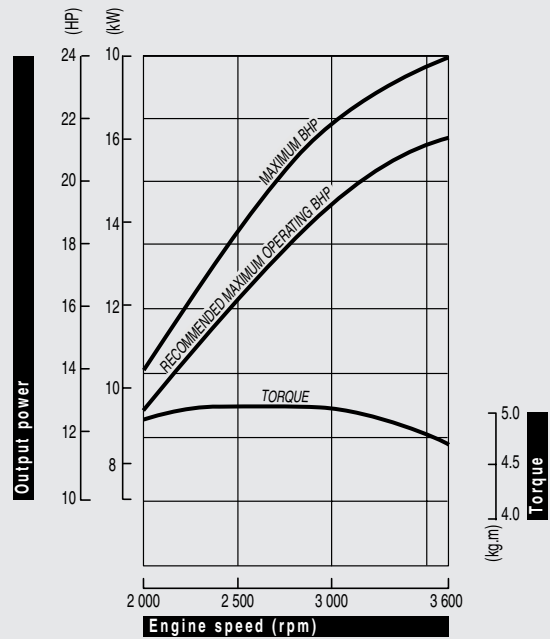
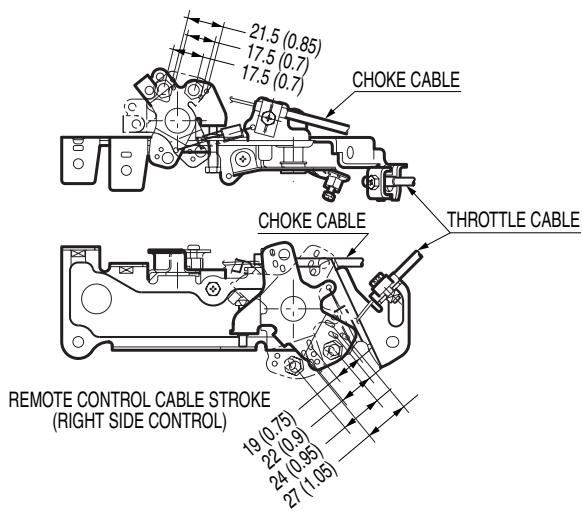
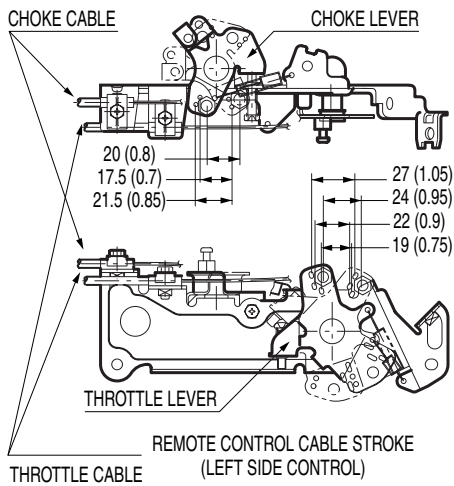

#### Performance curve

Horsepower rated in accordance with SAE J1995 (Gross)

For continuous operation, the BHP load should be less than 85% of maximum BHP

#### Courbe de puissance

Puissance mesurée selon SAE J1995 (Gross)

Pour une opération continue, la charge devrait être moins de 85% de la courbe "maximum BHP"

#### Leistungsangabe

Leistung gemessen nach SAE J1995 (Gross)

Für Dauerbetrieb sollte die Last weniger als 85% der "maximalen Leistungsangabe (max. BHP)" sein.

#### Curva di potenza

Potenza in conformità allo standard SAE J1995 (Gross)

Per uso continuativo, la potenza prelevata dovrà essere del 85% inferiore, rispetto a quella indicata nella curva "maximum BHP".

#### • T-TYPE

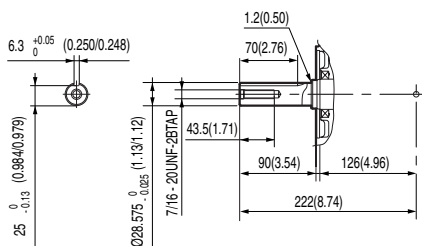

GX 670



## Specifications

Model	GX 670
Engine type	Air cooled 4 stroke OHV petrol engine, 90° V-twin design, horizontal shaft
Bore x stroke	77 x 72 mm
Displacement	670 cm <sup>3</sup>
Compression ratio	8.3 : 1
Max. power output	17.7 kW (24 HP) / 3 600 rpm
Maximum torque	50.8 Nm / 5.18 kgm / 2 500 rpm
Ignition system	Transistorised
Starting system	Electric starter
Specific fuel cons.	360 g/kW.hr - 265 g/HP.hr
Engine oil capacity	1.9 l
Dimensions (L x W x H)	412 x 471 x 457 mm
Dry weight	43 kg

## Spécifications techniques

Modèle	GX 670
Type du moteur	Moteur à essence bicylindre 4 temps OHV, refroidissement à air, cylindres en V de 90°, arbre de sortie horizontal
Alésage x course	77 x 72 mm
Cylindrée	670 cm <sup>3</sup>
Taux de compression	8.3 : 1
Puissance maxi	17.7 kW (24 ch) / 3 600 tr/mn
Couple maximal	50.8 Nm / 5.18 kgm / 2 500 tr/mn
Système d'allumage	Transistorisé
Système de démarrage	Démarrreur électrique
Cons. d'essence spéc.	360 g/kW.h - 265 g/ch.h
Capacité d'huile moteur	1.9 l
Dimensions (L x l x H)	412 x 471 x 457 mm
Poids à sec	43 kg

All specifications are subject to change without notice.  
Les caractéristiques techniques peuvent être modifiées à tout moment et sans préavis.

## Spezifikationen

Modell	GX 670
Motortyp	Luftgekühlter 2-Zylinder 4-Takt OHV Benzinmotor, 90° V-Twin, horizontale Kurbelwelle
Bohrung x Hub	77 x 72 mm
Hubraum	670 cm <sup>3</sup>
Verdichtung	8.3 : 1
Höchstleistung	17.7 kW (24 PS) / 3 600 min <sup>-1</sup>
Max. Drehmoment	50.8 Nm / 5.18 kgm / 2 500 min <sup>-1</sup>
Zündsystem	Elektronische Zündung
Starter	Elektrostarter
Spez. Kraftstoffverbrauch	360 g/kWh - 265 g/PSH
Motorölkapazität	1.9 Liter
Maße (L x B x H)	412 x 471 x 457 mm
Trockengewicht	43 kg

## Dati tecnici

Tipo	GX 670
Tipo di motore	Motore bicilindrico OHV ad albero orizzontale ciclo otto, 4 tempi, cilindri disposti a V di 90° raffreddamento ad aria forzata
Alesaggio x corsa	77 x 72 mm
Cilindrata	670 cm <sup>3</sup>
Rapporto di compressione	8.3 : 1
Potenza massima	17.7 kW (24 CV) / 3 600 giri/min
Coppia massima	50.8 Nm / 5.18 kgm / 2 500 giri/min
Accensione	A transistor senza contatti
Avviamento	Elettrico
Consumo combustibile	360 g/kWh - 265 g/CVh
Capacità coppa olio	1.9 l
Dimensioni (Lu x La x A)	412 x 471 x 457 mm
Peso a secco	43 kg

Le specifiche sono soggette a cambiamento senza preavviso.  
Die Spezifikationen können ohne Vorankündigung geändert werden.

Ref. EEC - TS 99/08 - GX 670

hella@iohta.com

**Germany • Honda Engines / Selling agent**  
Honda Logistik Center Deutschland GmbH  
Sprenölinger Landstraße 166  
D-63069 Offenbach/Main  
TEL: + 49 (0)6 98 30 95 17  
FAX: + 49 (0)6 98 30 91 28

**United Kingdom • Honda Engines / Selling agent**  
Honda Logistics Centre (UK) Ltd.  
Unit 3210, Wellington Parkway,  
Magna Park Lutterworth,  
Leicestershire LE 17 4JQ United Kingdom  
TEL: + 44 (0)1 45 55 59 429  
FAX: + 44 (0)1 45 55 59 428

**HONDA**  
ENGINES

**Honda Europe NV**  
EUROPEAN ENGINE CENTER  
Langerbruggestraat 104 • B-9000 Gent  
TEL: + 32 (0)9 250 12 11 • FAX: + 32 (0)9 250 14 24

**Italy • Honda Engines / Selling agent**  
Honda Logistic Centre Italy S.P.A.  
Via Strà, 153  
I-37030 Colognola ai Colli (VR)  
TEL: + 39 04 56 17 33 41  
FAX: + 39 04 56 15 12 70

**France • Honda Engines / Product information center**  
Parc d'Activités de Pariest  
Allée du 1er Mai  
Croissy Beaubourg  
F-77313 Marne-La-Vallée Cedex 13  
TEL: + 33 (0)1 60 37 31 18  
FAX: + 33 (0)1 60 37 33 66